

PASTURE WALK

in Rural O'Brien County, Iowa



Join us for an evening of hands-on education.

Thursday - June 22, 2023

5:30 p.m. Supper | 6:00-8:45 p.m. Program
Dustin Puhrmann Pasture

Directions: 3 miles east of Paullina on Hwy 10, 1 mile south on Hwy 10, turn right onto 470th St., go about 1/2 mile to Silver Ave., turn left onto Silver Ave., go about 1/2 mile to pasture on the left side of the road

No charge thanks to sponsorship from ISU Extension and Outreach, USDA Natural Resources Conservation Service and Cooperative Farmers Elevator.

Everyone is welcome!

Dress for the outdoors and pasture walking.

RSVP to Marsha at 712-957-5045 by June 16.

 Natural Resources Conservation Service
U.S. DEPARTMENT OF AGRICULTURE



This institution is an equal opportunity provider. For the full non-discrimination statement or accommodation inquiries, go to www.extension.iastate.edu/diversity/ext.

Topics to include:

- Pasture Condition Scoring
- Grazing Management
- Supplementation on Pasture
- Weed Control & Pasture Fertility
- USDA Pasture Improvement Funding

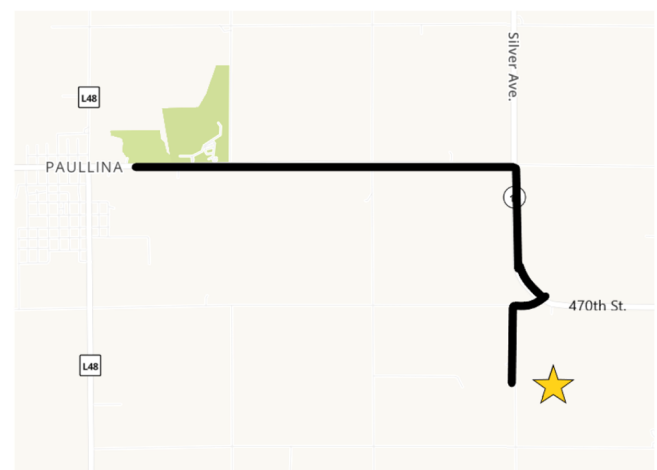

IOWA STATE UNIVERSITY
Extension and Outreach